

Integrated electronic controller PICO-T2

Contents:	Page
General informations:	
1. Functional features and installation dimensions	1
2. Terminal diagram	1
3. Method of operation	2
4. Adjusting the parameters	2
Summaries:	
5. Ordering key for pump	3
6. Retrofitting	3
7. Ordering key controller	4

Electronic pump PICO with integrated controller PICO-T2:

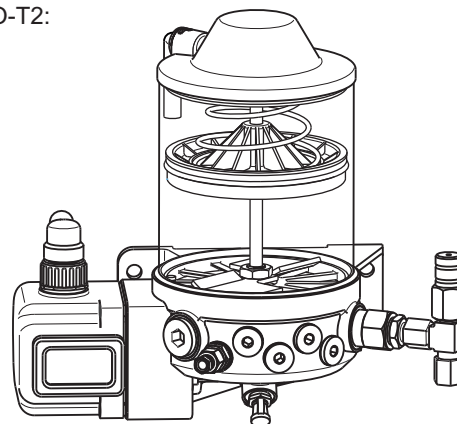

1. General informations:

The integrated controller PICO-T2 ensures time-out dependent control of the central lubrication pump PICO in progressive systems, especially on vehicles without continuous voltage supply, such as trailers or semi-trailers.

Installation dimensions:

The installation dimensions of the central lubrication pump PICO with integrated controller PICO-T2 correspond to the installation dimensions of a central lubrication pump without controller (see description PICO).

Technical data for the controller:

Operating voltage:	10 to 33 V DC
Max. current load:	I = 6.0 A
Fuse (not included in device):	F 6.3 A
	(5x20) medium
Temperature range:	-35°C to +75°C
Protection type:	IP 6

2. Terminal diagram:

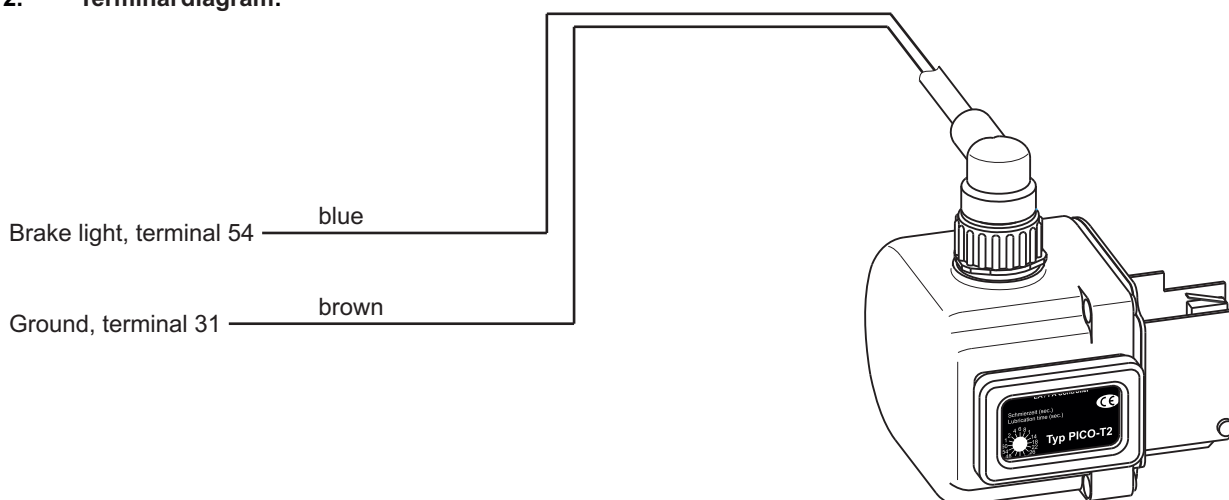

PICO-T2

Method of operation and adjusting the parameters

3. Method of operation

Time-out dependent control of a central lubrication system means that the lubrication time can be set.

Power supply of the pump is ensured via the brake light.

The central lubrication pump can only supply lubricant if the brake light is supplied with power, i. e. if the driver actuates the brake.

On each brake actuation, lubrication is started and continues over the preset lubrication time. Once the lubrication time has elapsed, the pump is switched off, even if the duration of the braking procedure exceeds the preset lubrication time. If braking is interrupted before expiry of the lubrication time, the pump is switched off. If the braking procedure is interrupted briefly (less than 1 second), this is ignored by the controller.

The central lubrication pump PICO has an integrated grease level control. If the minimum grease level is no longer reached, the pump will be switched off automatically.

4. Adjusting the parameters:

The lubrication time can be set by means of a graduating switch in the controller's sight glass.

To adjust the time setting, remove the red frame on the pump's motor housing using a flat screwdriver. Loosen the four Phillips screw and remove the transparent protective cover.

The lubrication time can be adjusted using a flat screwdriver.

If the cover plate is not replaced properly, water may enter the controller and damage it. In this case, the guarantee is no longer valid.

Adjusting the parameters:

Lubrication times:

- 1 sec., 2 sec.,
- 4 sec., 6 sec., 8 sec., 10 sec.,
- 14 sec., 18 sec., 22 sec., 26 sec., 30 sec.,
- 36 sec., 42 sec., 48 sec., 54 sec., 60 sec.

Lubrication time:

Braking longer than the lubrication time:

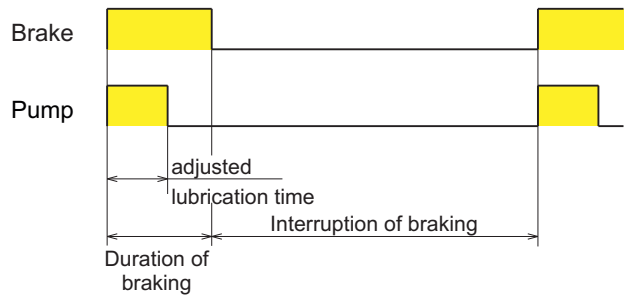

Braking with short interruptions:

(less than 1 sec.)

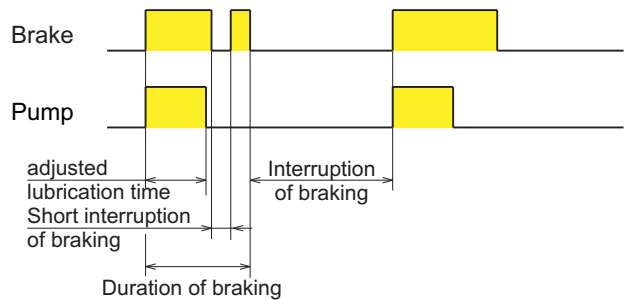

Braking shorter than the lubrication time:

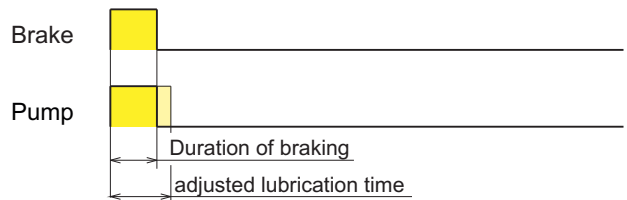

Integrated electronic controller PICO-T2:

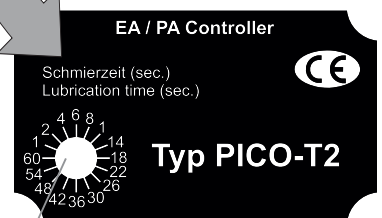
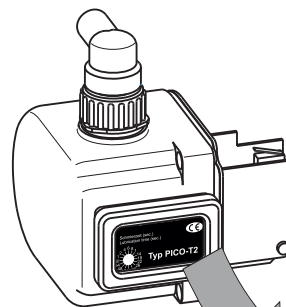

Graduating switch for setting the lubrication duration

2



PICO-T2

Ordering key PICO and retrofitting

5. Ordering key PICO with integrated controller:

Construction type:		2185 . 3 . 1 . 1 . 5 . 1 . 0000			
with bayonet connector					
Motor voltage	12 V	24 V			
Code	3	4			
Pump elements	Outlet-no.				
	4	10	4+10	without	
PE-120 F	1	2	3		
PE-120 FV	4	5	6		
PE-120 F + X	X		7	0	
PE-120 FV		X			
PE-120 F + X	X		8		
PE-120 FV	X				
Size of reservoir	1,2 kg				
Code	1				
Controller	PICO-T2				
Code	5				
Integrated electronic controller PICO-T2					
Lubricating time range		Code			
1 sec. to 60 sec.		1			
Special types	0000				

6. Retrofitting:

The integrated controller PICO-T2 can be retrofitted the electric pump PICO i. e. to pumps which have been delivered without controller and to replace existing controllers.

Controller delivered for retrofitting or replacement are not provided with connection cable, as this is normally available. If the controller is to be installed in a pump which has not been equipped with a controller so far, or to be replaced by a controller with another connector, the connecting cable must be ordered separately.

5-wire connecting cable, length 10 m, with bayonet connector:

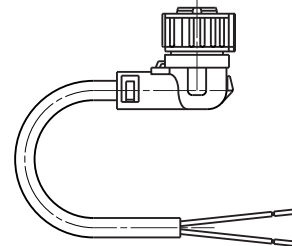

Order-no: FAZ02499-22



PICO-T2

7. Ordering key for integrated controller

